



PICTURE OF BUILDING (WEST SIDE)



PICTURE OF BUILDING (SOUTH SIDE)



PICTURE OF BUILDING (NORTH SIDE)



PICTURE OF BUILDING (EAST SIDE)

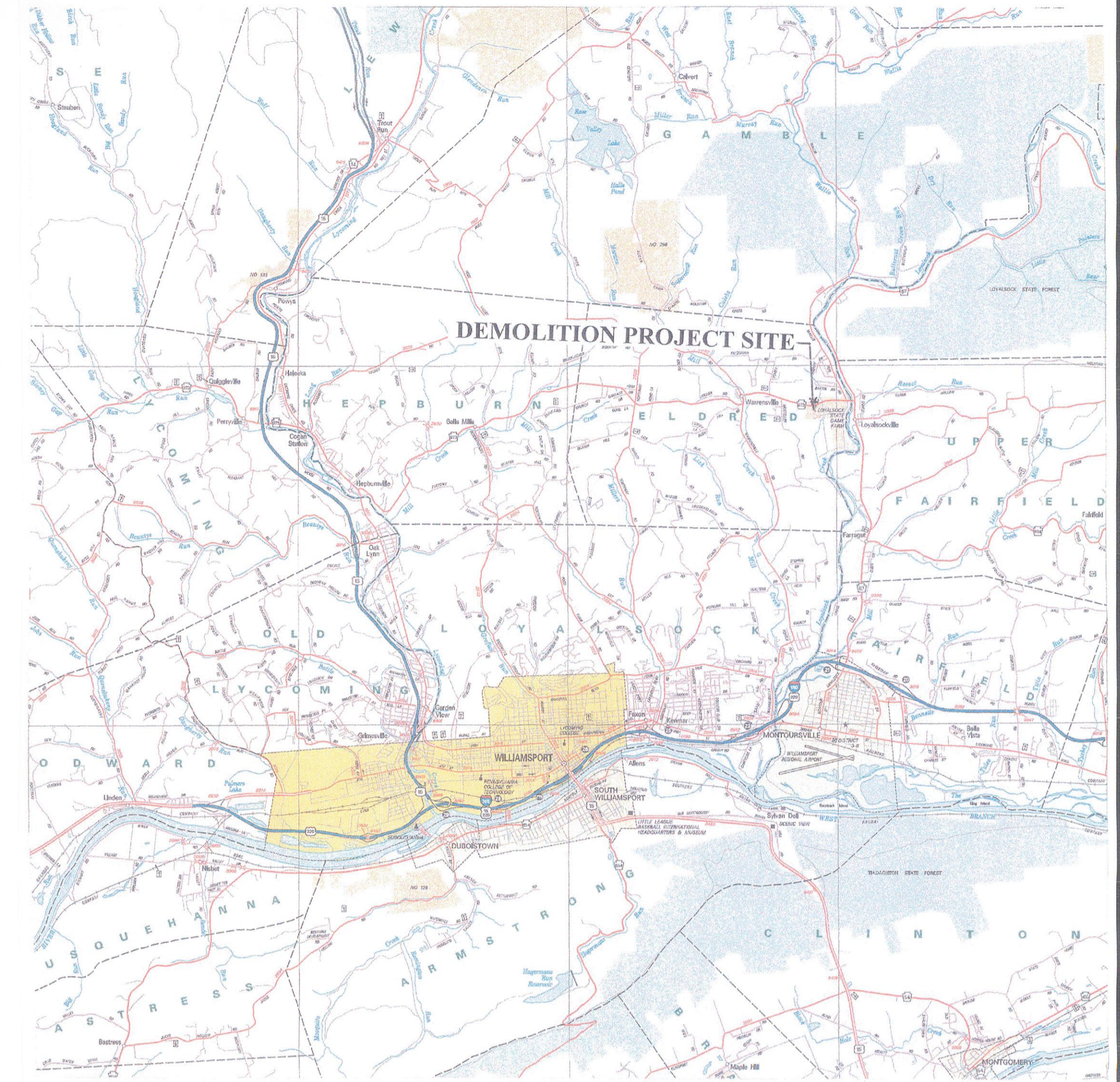

LOCATION MAP

SCOPE OF PROJECT

1. Demolish the wood shop building at the Loyalsock Game Farm. The building is a 1-1/2-story structure with a wood floor. The building is wood frame construction with aluminum siding and a metal roof. The footings / foundation of the building is a combination of concrete, block and stone. Burning or blasting is not permitted.
2. The foundation of the building is to be completely removed. The voids left by foundation removal are to be backfilled to grade with #2A coarse aggregate. The aggregate shall be compacted in layers not exceeding 6-inches in depth.
3. The PGC will disconnect the electric and phone service to the building before demolition begins.
4. The Contractor shall coordinate demolition with the game farm staff to minimize disruptions to game farm operations.
5. Remove and properly dispose of all interior items, trash and debris inside the building.
6. The Contractor is allowed to salvage any building materials (wood framing, aluminum siding, garage doors, etc.) to offset the costs of the project.
7. All building components, contents, trash and litter must be removed from the site. Demolition debris and trash must be disposed of at a DEP approved landfill.

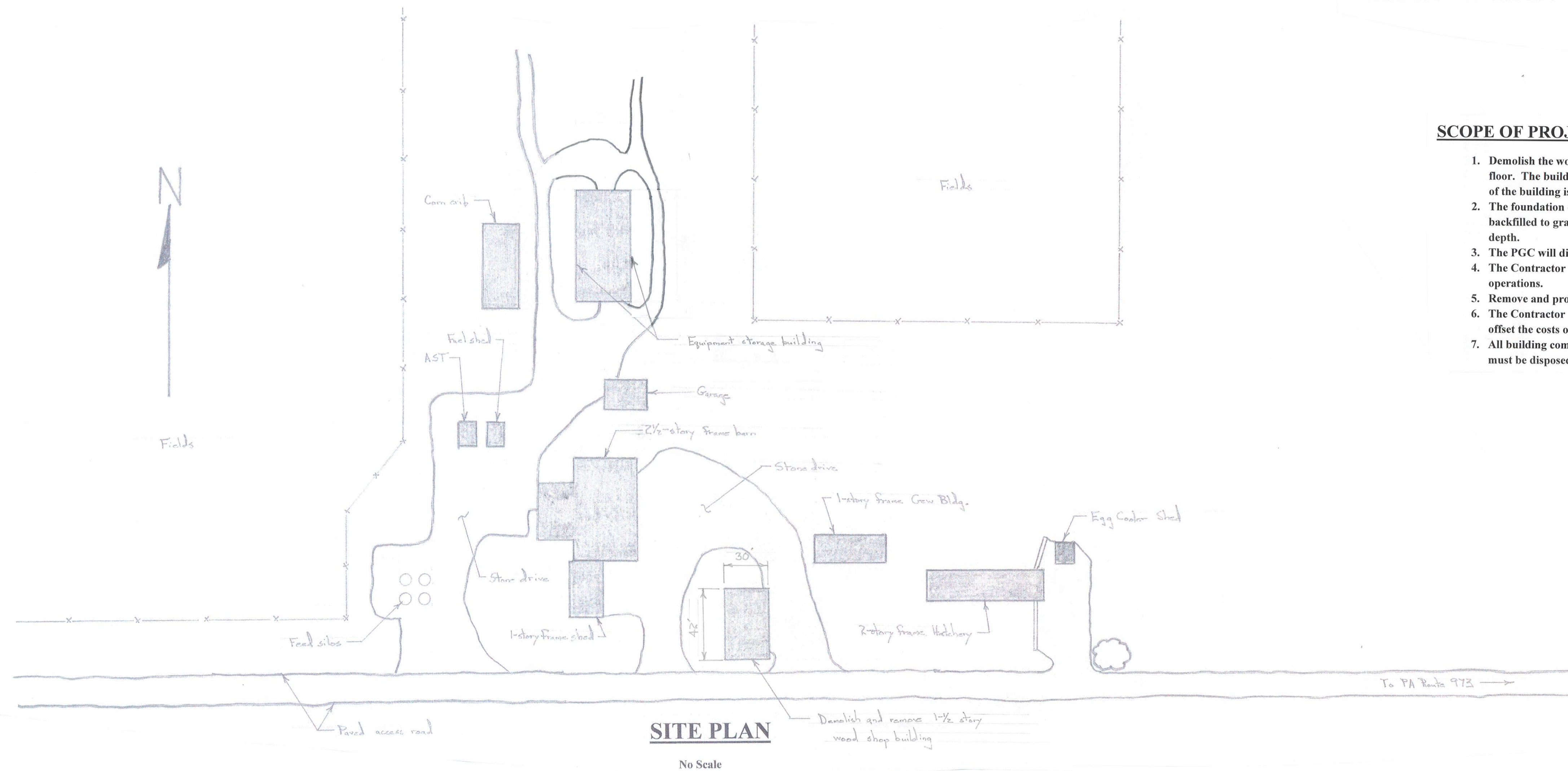

SITE PLAN

No Scale

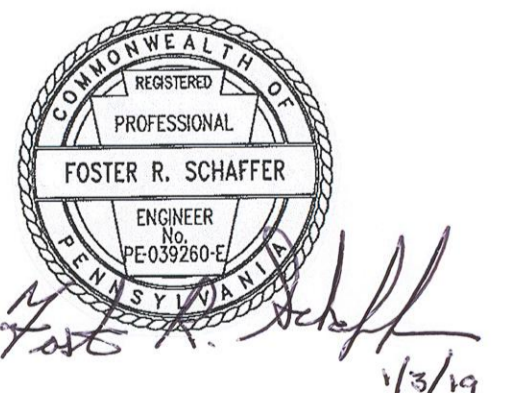

PENNSYLVANIA GAME COMMISSION		
LOYALSOCK GAME FARM	ELDRED TWP.	LYCOMING CO.
DEMOLITION OF WOOD SHOP BUILDING (SB#174)		
LOCATION MAP, SITE PLAN, DETAILS AND NOTES		
REVISIONS		PROJECT NO. PGC-LGF-19-1
△		DRAWN BY: JS
△		DATE: 01/05/19
△		SHEET NO. 1 OF 1